

WARNING!

Health and Safety information
contained within.
Incorrect set-up can damage this
equipment.

**READ THIS MANUAL
BEFORE USE!**



HanolexTM

HPX1

Eyelet Press

Designed and built in
the UK



User Manual

Self-Piercing Dies

CONTENTS

Description	2
Important safety information	2
Before first use	2
About the machine	3
Maintenance	3
Combi Dies - Operation	5
Combi Die - Installation	6

DESCRIPTION

- These instructions describe and illustrate the setup and operation to insert self-piercing eyelets using a HPX1 hand press.
- By changing the dies, different sized eyelets can be fitted
- Self-piercing eyelets are ideal for vinyl and other solid but flexible materials, they may not be suitable for some woven cloths or similar materials. In these cases holes in the materials should be made prior to eyeletting

IMPORTANT SAFETY INFORMATION

- Be aware that there can be sharp cutting edges on the dies.
- Keep hands away from dies when applying pressure.
- Keep hands away from the internal mechanism of the press.
- Follow the setup routines explained in this manual before first use.
- Always follow maintenance routines explained in the maintenance section.
- Please contact your supplier if there is anything you don't understand.

BEFORE FIRST USE

- Wipe off any excess oil from the machine that would have been applied during assembly and storage
- The machine will usually be supplied with the dies fitted and ready to use "out of the box" however if this is not the case and the dies need to be fitted or you are changing the dies for another size for example you must follow the set up procedure laid out in these instructions.
- Failure to follow the setup procedure could damage the dies and invalidate the warranty.

ABOUT THE MACHINE.

This machine allows the user to insert eyelets and other fasteners in various types of fabric, leather and other materials, by changing the dies different size eyelets can be fitted.

This manual describes and illustrates the setup and operation procedure to insert eyelets using a HPX1 Eyelet Machine using the combination dies; the process is the same for all sizes of eyelet when using combination dies.

Alternative instructions are available if you are using separate V-cutter & Setting dies in Appendix A at the back of this manual.

Remove the machine and other parts from the packaging. The standard machine is usually supplied assembled and ready for use. In addition to this booklet and the setting tools you have ordered the following should also be included:

1. 1 x HPX1 Press body
2. 1 x Operating Handle
3. 1 x Adjustable Material Back Stop
4. 2 x Hexagon keys (3mm, 5mm)

Also shown are typical tools

5. Upper Die (size will vary depending on order)
6. Lower Die (size will vary depending on order)

IF REQUIRED THIS MACHINE CAN BE FIXED TO A SUITABLE SURFACE IF REQUIRED

However this is not necessary for normal operation and can prove more convenient if kept mobile.

If you wish to fix the machine to a suitable surface there are 4 mounting holes provided in the base of the press for this purpose.

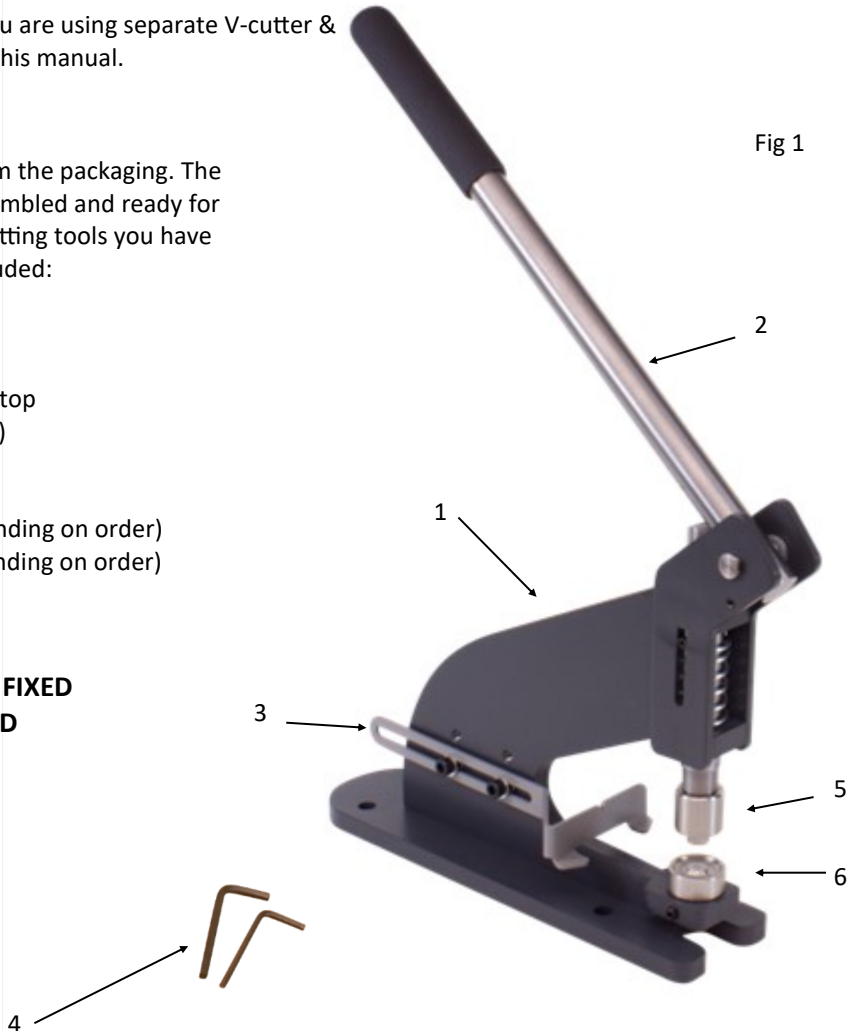

MAINTAINANCE

Lubrication

The mechanism of the press should be oiled to keep it working correctly.

A basic machine oil such as 3in1 Oil for example is sufficient, apply it to the areas indicated in red on the image to the right.

The best rule of thumb is "little and often" applying too much oil will cause it to drip down on to the setting dies and could mark your material.



SELF-PIERCING DIES - Operation

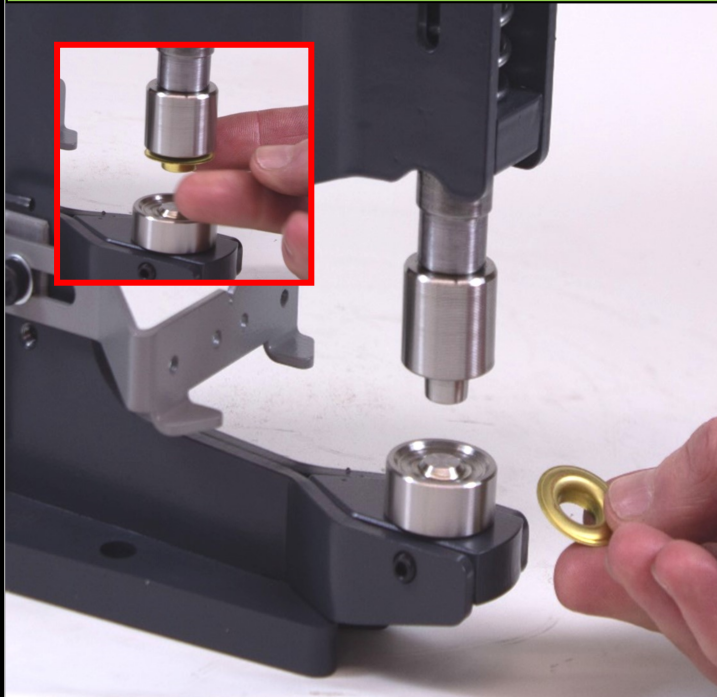

Step 1: Press the eyelet on the spring-loaded pin on the top die. This will stay in place for the setting operation.



Step 2: Place washer (hollow side up) in the recess of the bottom die.

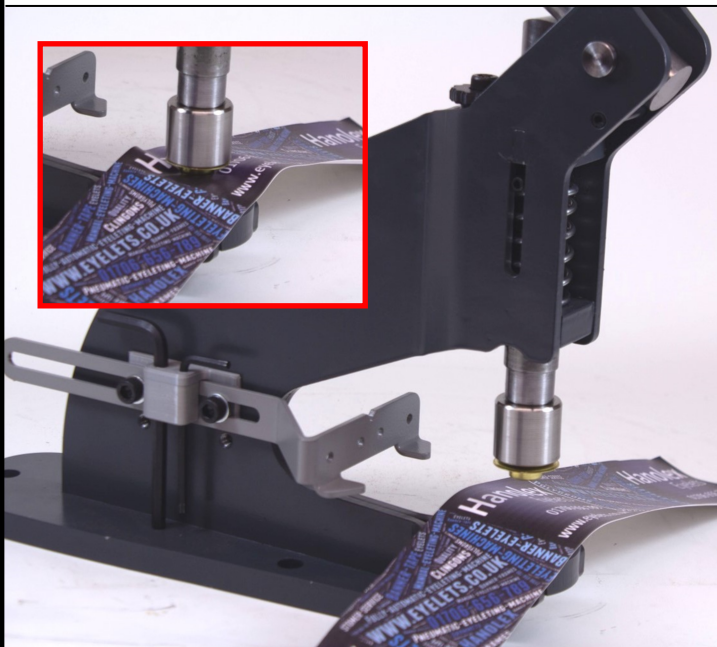

Step 3: Place your material over the bottom die in the position where you desire the eyelet to be fitted. Apply firm pressure to the press handle, the barrel of the eyelet will cut through the material and begin to roll back on itself gripping the material between the eyelet and ring.



Step 4: Inspect the eyelet fitting to ensure the eyelet has gripped the material sufficiently, if the eyelet is loose in the material reapply pressure to the eyelet as in step 4 until a satisfactory result is achieved.

SELF-PIERCING DIES - Installation



Step 1. Screw the top die into the underside of the vertical rod.

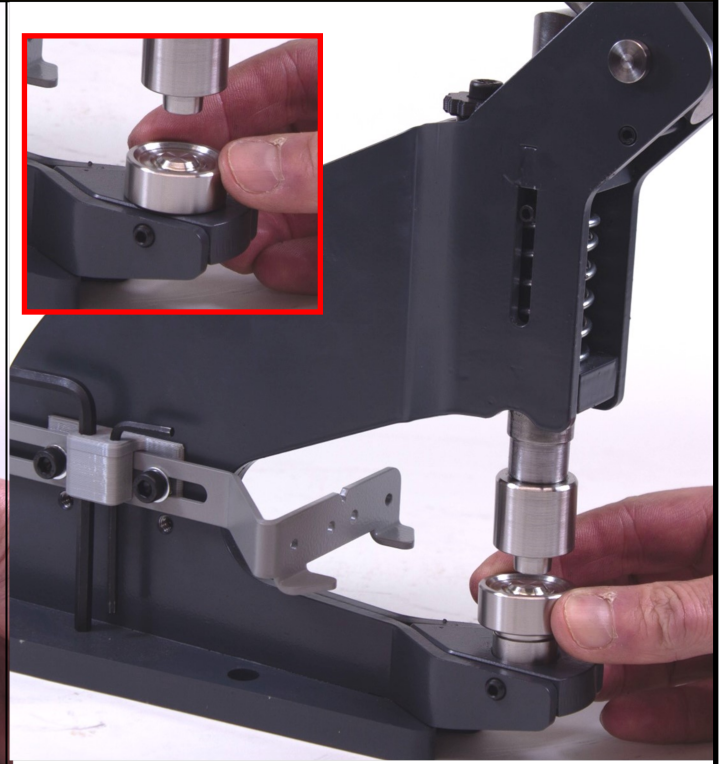

Step 2. Drop the bottom die into the holder on the machine base

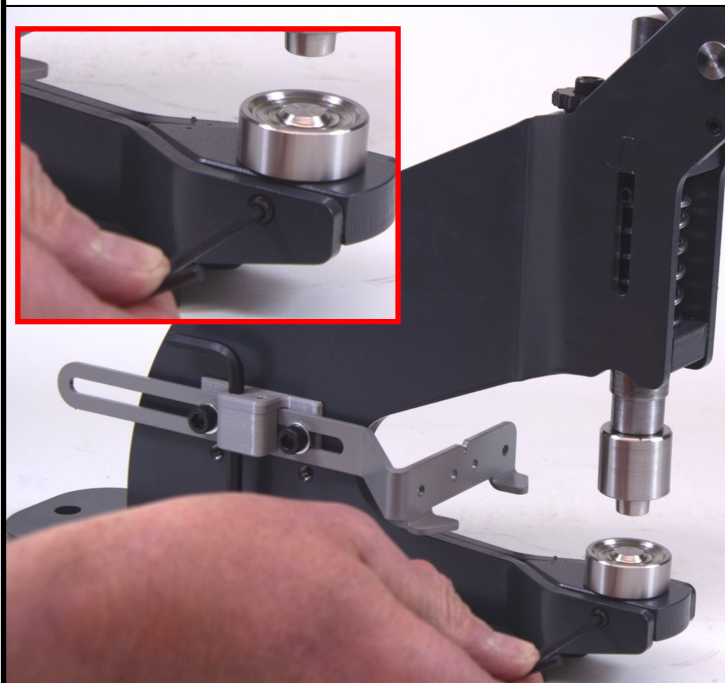

Step 3: use a hexagon Key to tighten the bottom die in place

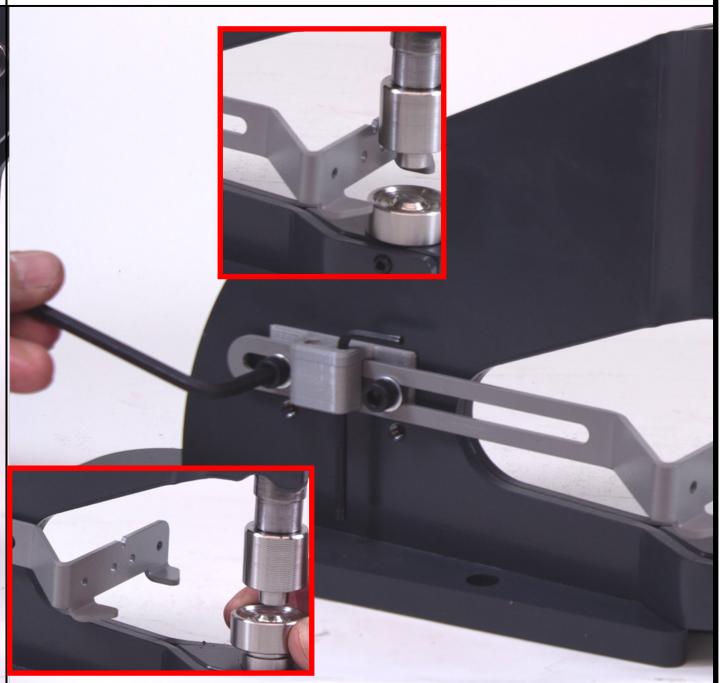

Step 4: You can move the backstop forwards or backwards to allow equal spacing between the fabric and each eyelet



© Hanolex Ltd.

Hanolex Ltd.
246 Whitworth Road, Rochdale
Lancashire
OL12 0JL
United Kingdom

www.eyelets.co.uk

+44 (0) 1706 656789